

FILED FOR RECORD  
At 11:37 O'clock 9 M

AUG 23 2001

SUE HODGES  
Clerk and Recorder  
Benton County, ARK.

OWNERS CERTIFICATION

WE, THE UNDERSIGNED, DO HEREBY CERTIFY THAT WE ARE THE SOLE OWNERS OF THE HERIN PLATTED PROPERTY AND DO HEREBY DEDICATE ALL STREETS AND EASEMENTS FOR THE USE OF THE GENERAL PUBLIC AND FOR INSTALLATION OF UTILITIES.

*Steve Bloxham, Sr.*

STATE OF ARKANSAS)  
COUNTY OF SS BENTON )  
SUBSCRIBED AND SWORN BEFORE ME THIS 23 DAY OF Aug, 2001

*Sandy Easley*  
NOTARY PUBLIC

10-16-10  
MY COMMISSION EXPIRES

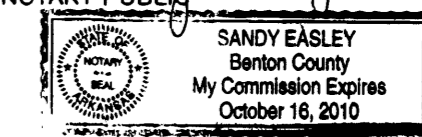

PROPERTY DESCRIPTION

PART OF THE NE 1/4 OF THE SW 1/4 OF SECTION 25, TOWNSHIP 21 NORTH, RANGE 30 WEST, BENTON COUNTY, ARKANSAS, BEING MORE PARTICULARLY DESCRIBED AS FOLLOWS:

COMMENCING AT THE SW CORNER OF THE SE 1/4 OF THE SW 1/4 OF SAID SECTION 25; THENCE N 02°28'59"E 1606.44 FEET; THENCE S 87°31'01"E 391.89 FEET FOR THE POINT OF BEGINNING; THENCE N 2°42'41"E 685.45 FEET; THENCE S 87°40'15"E 919.95 FEET; THENCE S 2°22'41"W 81.80 FEET; THENCE N 87°40'04"W 369.88 FEET; THENCE S 2°19'07"W 253.68 FEET; THENCE N 87°40'09"W 16.81 FEET; THENCE S 2°15'01"W 142.79 FEET; THENCE S 87°19'06"E 219.74 FEET; THENCE S 6°17'48"W 90.18 FEET; THENCE N 87°19'06"E 213.38 FEET; THENCE S 2°15'01"W 118.47 FEET; THENCE N 87°32'01"W 538.30 FEET TO THE POINT OF BEGINNING, CONTAINING 9.71 ACRES MORE OR LESS, AND BEING SUBJECT TO ANY AND ALL EASEMENTS OF RECORD OR OF FACT.

PLANNING COMMISSION ACCEPTANCE  
THIS PLAT IS ACCEPTED THIS 21<sup>ST</sup> DAY OF AUG, 2001.

*James C. Dole*  
CHAIRMAN

CITY COUNCIL ACCEPTANCE  
THIS PLAT IS ACCEPTED THIS 21<sup>ST</sup> DAY OF Aug, 2001.

*Jackie Colton* *John Burkett*  
MAYOR CITY CLERK

*Bloxham Estates*  
Block 1, Lots 1-28, & Block 2, Lot 1

BLOCK 1

LOT #	ACRES	LOT #	ACRES
1	0.23	15	0.35
2	0.19	16	0.36
3	0.22	17	0.23
4	0.22	18	0.23
5	0.34	19	0.23
6	0.33	20	0.24
7	0.22	21	0.24
8	0.22	22	0.21
9	0.32	23	0.21
10	0.31	24	0.24
11	0.21	25	0.24
12	0.22	26	0.21
13	0.22	27	0.21
14	0.22	28	0.24

BLOCK 2

LOT #	ACRES
1	0.69

STREET DEPT. ACCEPTANCE  
THIS PLAT IS ACCEPTED THIS 22 DAY OF Aug, 2001.

*David A. Huff*  
STREET SUPERINTENDENT

ALL LOTS HEREON PLATTED ARE GOVERNED BY COVENANTS AND RESTRICTIONS RECORDED AT 01-128590 BENTON COUNTY RECORDS.

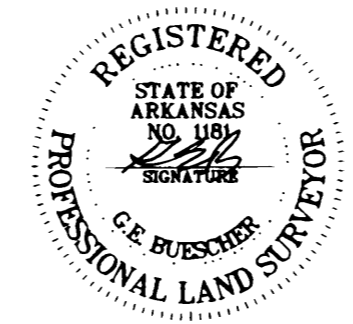

FLOOD CERTIFICATION :  
THIS PROPERTY IS NOT LOCATED WITHIN A PRESENTLY ESTABLISHED 100 YEAR FLOOD PLAIN, AS DETERMINED BY THE NATIONAL FLOOD INSURANCE PROGRAM, FLOOD INSURANCE RATE MAP FOR BENTON COUNTY, ARKANSAS, PANEL NUMBER 05007C0075 E EFFECTIVE DATE : SEPTEMBER 18, 1991

SURVEYOR'S DECLARATION:  
I HEREBY DECLARE THAT I HAVE THIS 23 DAY OF AUG, 2001 COMPLETED A SURVEY OF THE ABOVE DESCRIBED PROPERTY. THE PROPERTY LINES AND CORNER MONUMENTS ARE, TO THE BEST OF MY KNOWLEDGE AND ABILITY, CORRECTLY ESTABLISHED, AND THERE ARE NO ENCROACHMENTS EXCEPT AS SHOWN ON THIS PLAT.

*Gene E. Gueschen*

P487

SW CORNER  
SE 1/4, SW 1/4  
25-21-30

- LEGEND
- FOUND IRON PIN
  - SET IRON PIN
  - BUILDING SETBACK
    - 25' FRONT
    - 10' SIDE
    - 20' REAR
  - UTILITY & DRAINAGE EASEMENT
    - 20' FRONT
    - 15' REAR (UNLESS OTHERWISE SHOWN)
  - SIDEWALKS PER PEA RIDGE AND ADA SPECIFICATIONS

